

RECOMMENDED PCB FOOTPRINT

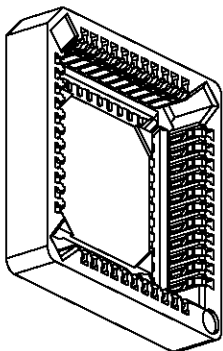

NOTES:

1.MATERIAL:

HOUSING:POLYPHENYLENE(PPS),GLASS FIBER FILLED

UL94V-0 COLOR:BROWN

CONTACT:PHOSPHOR BRONZE

PLATING:

CONTACT MATTE TIN PLATING OVER NICKEL.

2.MECHANICAL

MATING FORCE: 7Kg.f MAX.

UNMATING FORCE: 0.45Kg.f MIN.

DURABILITY(mating cycles):20CYCLES MIN.

3.ELECTRICAL

CURRENT-MAXIMUM : 1.00 AMP.

VOLTAGE-MAXIMUM : 500V

CONTACT RESISTANCE: 20 mΩ MAX.

4. ENVIRONMENTAL

TEMPERATURE RANGE-OPERATING: -55° C TO + 115° C.

Ordering Information

X — 1511 — XXS0 — 118 — 0010

RoHS		Number of contacts		Contacts type		Insulator material		Contacts plating	
Code	Definition	Code	No of contacts	Code	Definition	Code	Definition	Code	Definition
Blank	Non-RoHS	32	32 PIN	S	"S" form	1	PPS	1	Tin plated 150u"
R	RoHS	44	44 PIN			2	PBT	2	Gold finish
								8	Matte Tin plated 150u"

NDJDF CONTACT	DIM.A ±0.15	DIM.B ±0.15	DIM.C ±0.15	DIM.D ±0.15	DIM.E L 14.42 W 11.88	DIM.F
32	20.50	17.90	10.16	7.62		2.65
44	23.00	23.00	12.70	12.70		2.95

UNITS		NAME:		TITLE:		SCALE		SHEET		REV.	
X ±0.30	M	M	M	PLCC SMT "S"TYPE SOCKET	深圳市君瀚精密工业有限公司	BP-C-151-1270-0078	1:1	1/1	A0		A0
X ±0.20				PART NO.:	SHENZHEN JINHAN ENGINEERING CO., LTD						
XX±0.10				R-151-XXS0-118-0000							
X* ±2*				FINISH							
				APPD:							
				CHKD:							
				DR:							

REV.	ECN NO.	APPD	DATE
A0			07/11/02