

SIGN	DATE	DESCRIPTION	APPROVER
△			
△			
△			

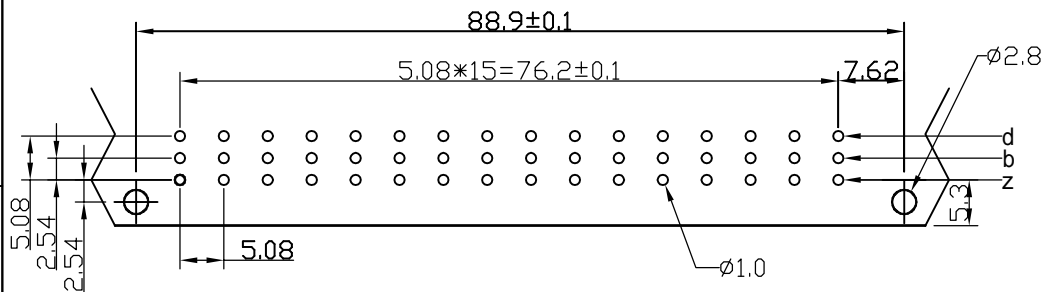
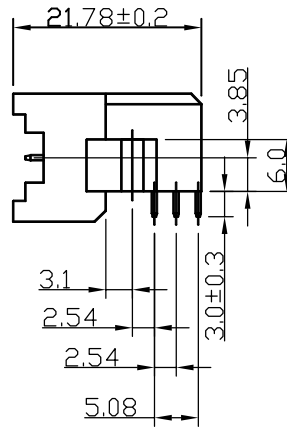
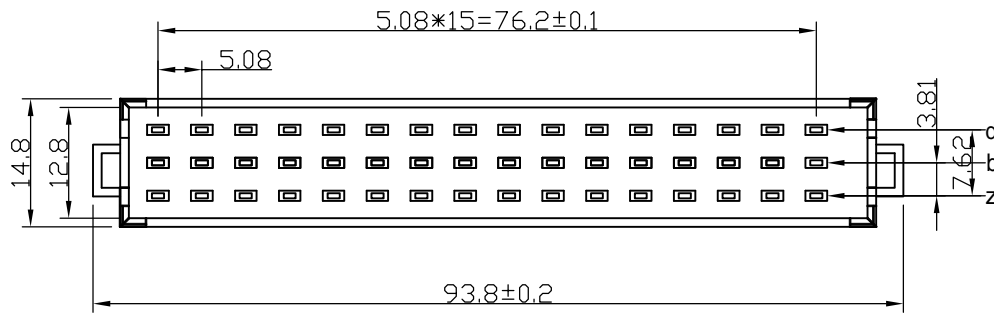
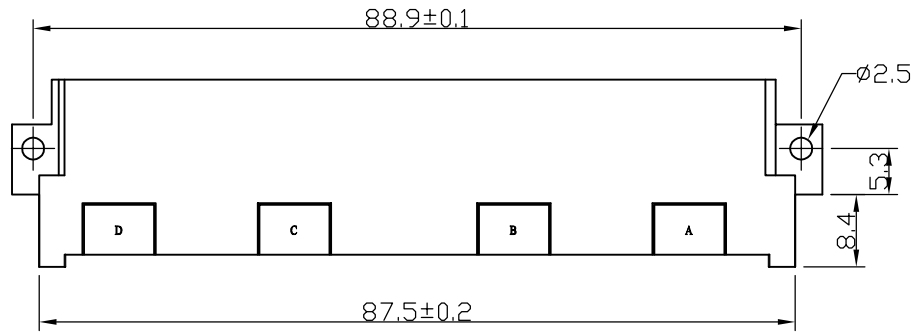

P.C.Board Layout

MATERIAL:  
Housing:30%Glass filled PBT  
UL94V-0

Contacts:Brass

ELECTRICAL CHARACTERISTICS:  
Current Rating:2AMP  
Dielectric Withstanding Voltage:  
AC1000V For 1minute  
Insulator Resistance:  
1000MΩ min at DC500V  
Contact Resistance:  
30MΩ min at DC100mA  
Operating Temperature:  
-55°C to +105°C



深圳市君灏精密工业有限公司  
SHENZHEN JUNHAO ENGINEERING CO., LTD

PART. NAME: 348弯针欧式插座(F型)				TITLE:	
PART. NO.: 710F-1100-3148-R				DWG NAME:	
APPROVED BY	CHECKED BY	DESIGNED BY	DRAWN BY	CUSTOM NO.:	Tolerance
			Jacky		x. ±0.50
				UNITS: mm	x.x ±0.30
				SCALE:	x.xx ±0.10
				REVISION:AO	xx* ±1°