

SIGN	DATE	DESCRIPTION	APPROVER
▲	20181226	Add Part No. and nextron logo	Jacky Liu

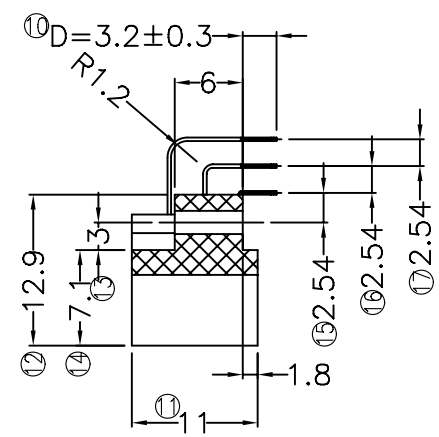
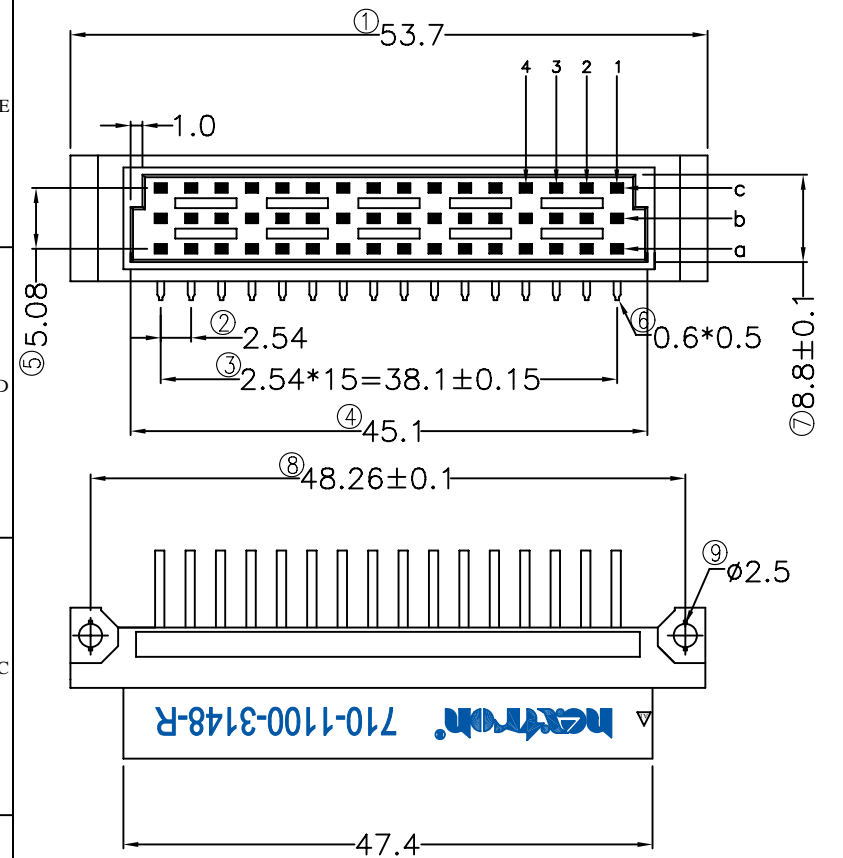

Material:
Housing: 30% Glass filled
PBT UL94V-0
Contacts: Brass.

Electrical Characteristics:
Current Rating: 2 AMP.
Dielectric Withstanding Voltage:
1000V for 1 minute.
Insulator Resistance:
1000MΩ min. at DC 500V
Contact Resistance:
30mΩ max. at DC 100mA.
Operating Temperature:
-55°C ~ +105°C.

Ordering Information

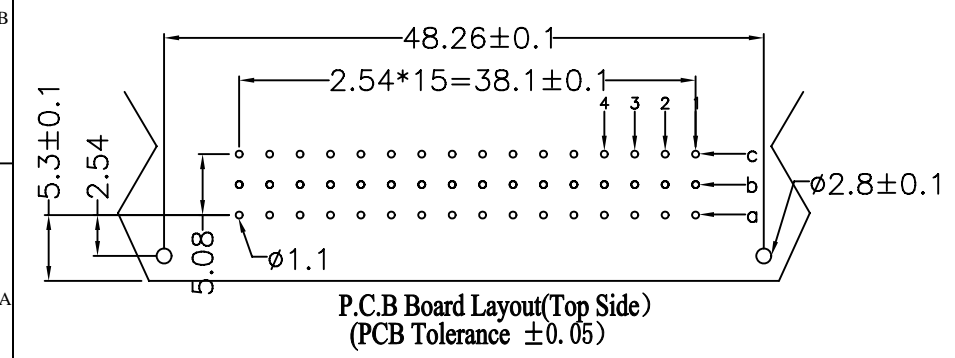
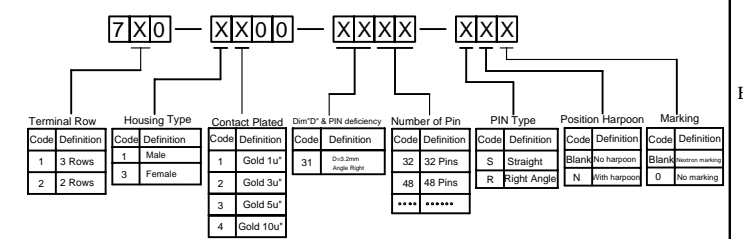

JHJM 深圳市君灏精密工业有限公司
SHENZHEN JUNHAO ENGINEERING CO.,LTD

PART. NAME: 348弯针欧式插座				TITLE: DIN41612/348弯针/有字			
PART. NO.: 710-1100-3148-R				DWG NAME: C-710-1100-3148-001			
APPROVED BY	CHECKED BY	DESIGNED BY	DRAWN BY	CUSTOM NO.:		Tolerance	
J&S	jeff	EDSON	Jacky	UNITS: mm		x. ±0.30	
			2022.09.23	SCALE:		x.xx ±0.20	
				REVISION:A1		xx' ±0.10	
						±1'	